

Replace starter rope on Quick Cut

This example use a **Husqvarna K760**, but many machines are similar.

Remove starter:

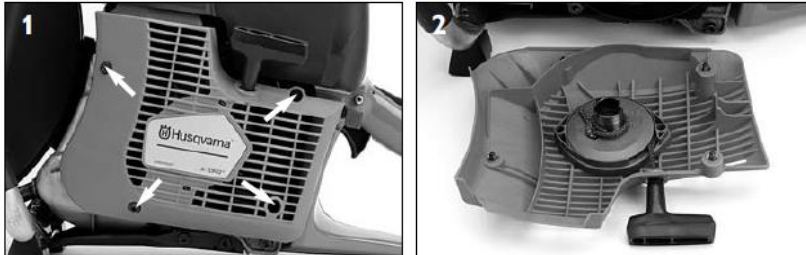

Starter

1. Loosen the starter's 4 screws.
2. Remove the starter.

Tip - Use the multi tool provided with the machine

Replace rope:

STARTER

5

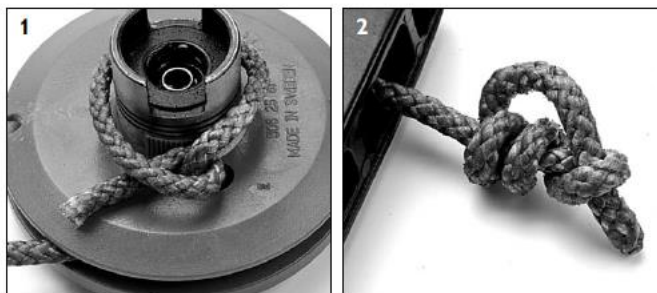
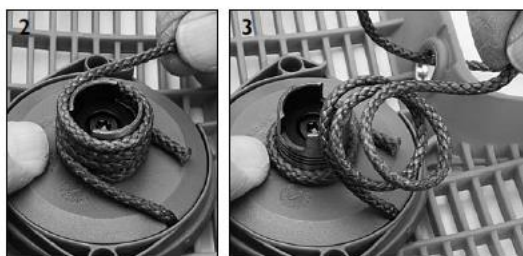

Replacing the starter cord

Dismantle the starter.

Eliminate the spring force from the return spring

1. Pull out the starter cord approximately 12 in./30 cm. Hold the starter pulley with your thumb and place the cord in the cut-out on the starter pulley.

2. Let the starter pulley rotate slowly and wind up the cord on the metal sleeve.

3. Lift off the cord from the starter pulley.

Attach the new starter cord

The starter cord should be 45 in./115 cm long and have a diameter of .16 in./4 mm.

1. Insert one end of the cord from the top through the hole in the starter pulley and then out through the notch for the cord. Pull out virtually the whole cord length until sufficient cord remains to tie a knot as illustrated.

2. Insert the other end through the cover and on through the handle. Tie a double knot as illustrated.

Tip - You can cut rope on an angle and melt the end so it becomes a point (new ropes are usually pre cut and melted).

Tip - If you put the rope into the pulley's top hole first, then out through the pulley, you will find it much easier.

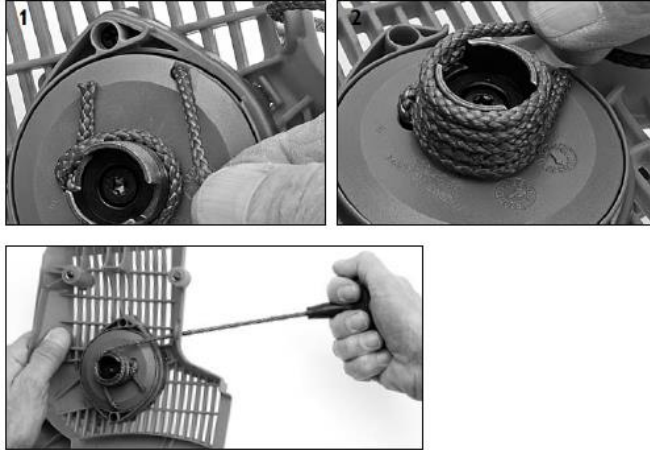

Loading the return spring

1. Fit the starter cord in the cut-out.

2. Wind the start cord 4 turns around the hub and pull out the starter handle and release so that the cord is wound into the starter pulley. Repeat the procedure with 3 turns of cord around the hub.

Important check!

Check that the return spring does not act as an end stop by extending the cord fully. In this position it should be possible to turn the starter pulley a least a further half turn before the spring stops the movement.

Refit starter:



Fitting the starter

Do as follows so that the starter pawls come into the right position against the starter pulley sleeve: First pull out the cord about a half meter. Keep this position when the starter is set against the machine and slowly release and the starter pawls will take on the correct position.

Tighten the four screws on the starter to a torque of 5-6.5 lbf-ft/7-9 Nm.

Bibra Lake 0419 901 533

UNITED
DAMOND
TOOLS

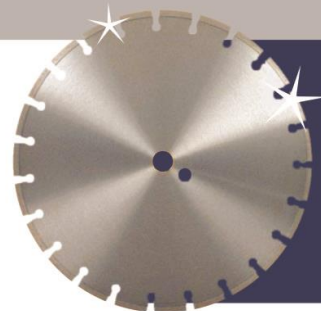

Unit 10 / 84 Barberry Way
Bibra Lake WA 6163
Tel 08 9434 6878
Mob 0419 901 533
sales@udt.com.au
www.udt.com.au
ABN 12 621 543 173