

5" Stone Grinders Exploded View(1200W)

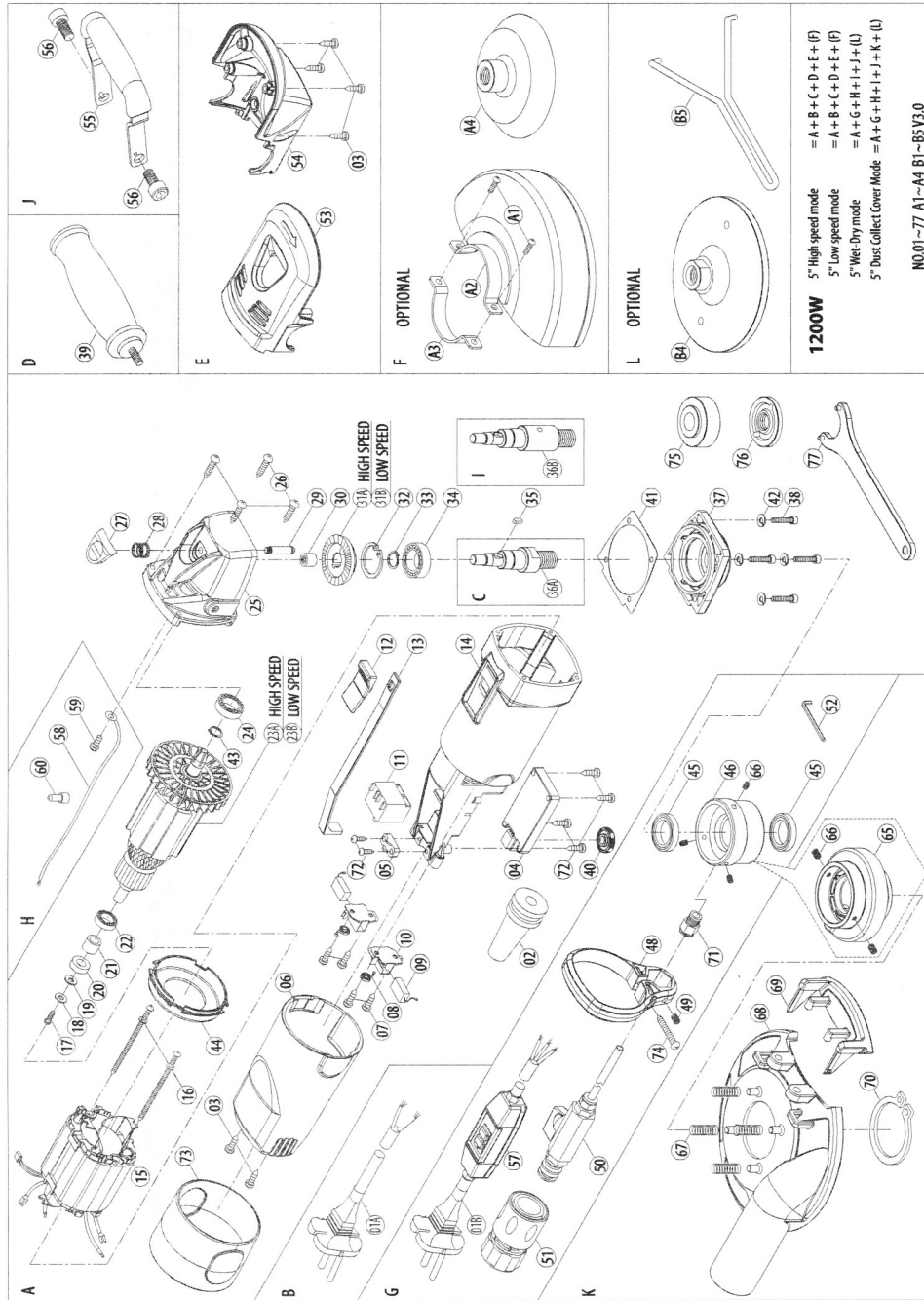

5" Low speed model Stone Grinders Parts List (1200W)

NO.	Parts Name	Q'TY	NO.	Parts Name	Q'TY
1A	POWER SUPPLY CABLE	1	30	NEEDLE BEARING HK 0810	1
1B	N/A	-	31B	BEVEL GEAR-LOW SPEED M1.15 x 43T (LOW SPEED)	1
2	CORD ARMOR	1	32	INTERNAL CIRCLIP R-35	1
3	SCREW M4 x 16	6	33	EXTERNAL CIRCLIP S-15	1
4	ELECTRONICS BOARD	1	34	BEARING 6202-2RS	1
5	CABLE CLIP	1	35	PARALLEL KEY 3 x 3 x 8	1
6	TAIL COVER	1	36A	SPINDLE M14	1
7	SCREW M4 x 10	4	37	GEAR PLATE	1
8	SPIRAL TORSION SPRING	2	38	SCREW M4 x 16	4
9	CARBON BRUSH 7 x 11 + 33L + FLDNBI-110	2	39	SIDE HANDLE	1
10	CARBON BRUSH HOLDER	2	40	THUMB WHEEL	1
11	SWITCH	1	41	GASKET	1
12	SWITCH SLIDER	1	42	SPRING WASHER M4	4
13	SWITCH LEVER	1	43	EXTERNAL CIRCLIP S-12	1
14	MOTOR HOUSING	1	44	FAN BAFFLE	1
15	STATOR	1	45-52	N/A	-
16	STATOR SCREW M4 x 60	2	53	GEARBOX COVER - UPPER	1
17	SCREW M4 x 10	1	54	GEARBOX COVER - LOWER	1
18	FLAT WASHER $\phi 4 \times \phi 10 \times 1$	1	55-71	N/A	-
19	PLASTIC WASHER $\phi 4 \times \phi 11 \times 1$	1	72	SCREW M4 x 14	6
20	PICKUP MAGNET $\phi 8 \times \phi 15 \times 5$	1	73	RUBBER SLEEVE	1
21	SPACER $\phi 8 \times \phi 12 \times 10.5$	1	74	N/A	1
22	BEARING 608-2RU	1	75	INNER FLANGE	1
23B	ARMATURE-LOW SPEED M1.15 x 6T (LOW SPEED)	1	76	OUTER FLANGE	1
24	BEARING 6001-1LU	1	77	LOCK NUT WRENCH	1
25	GEAR CASE	1	(Optional for model High speed model&Low speed model)		
26	SCREW M4 x 25	4	A1	SCREW M4 x 10	2
27	SPINDLE LOCK BUTTON	1	A2	GUARD	1
28	COIL SPRING $\phi 0.9 \times \phi 10 \times \phi 11.8 \times 13.5L \times 4T$	1	A3	GUARD BRACKET	1
29	SPINDLE LOCK	1	A4	4" SANDING PAD 4"	1